

# ATLANTIC SOFT CLOSE HINGE

530 Glass to wall for 10mm (3/8") - 12mm(1/2") glass

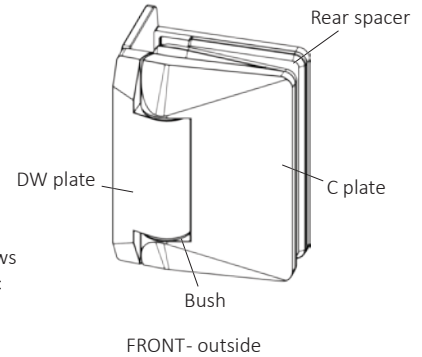
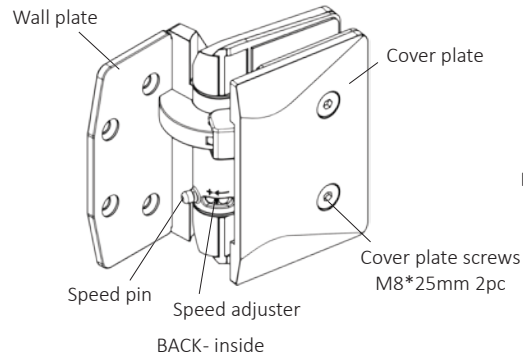
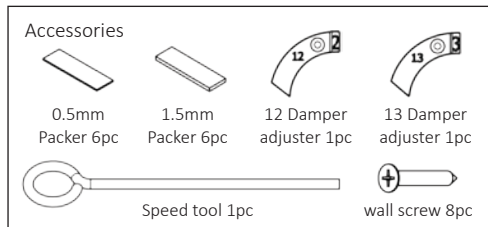

## Installation

1. Check the wall or post alignment, making sure it is plumb and level. Also make sure the glass latch panel or post is plumb and in alignment.



Watch the install video



4. Place the gate panel with the fixed hinges into position on some timber blocks at the desired level and make sure it is plumb.

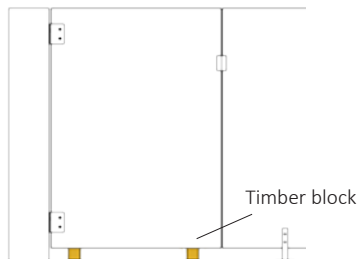

2. Undo the cover plate screws completely, then screw them back in 2 to 3 turns. For 12mm (1/2") panel, remove the rear spacer. For 10mm (3/8") panel leave the rear spacer in.

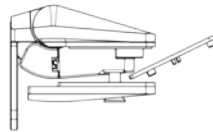

5. Pre drilling the holes for harder timbers or masonry. Then secure the first 2 wall screws on the top hinge into the timber. Repeat for the lower hinge. carefully open the gate and secure the other 2 screws on each hinge.

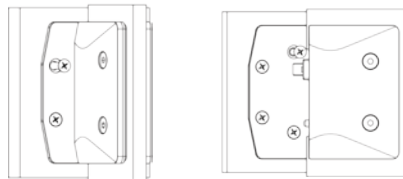

3. Take one hinge and slide it into the gate panel. With the hinge in the center of the cutout push all the way to the back of the cutout tighten the cover plate screws. Repeat these steps for the lower hinge.

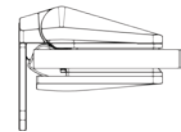

6. Push packers in above the hinge for the glass to rest on. They should be pushed in past the level of the glass (see diagram). Repeat step 6 for bottom hinge.

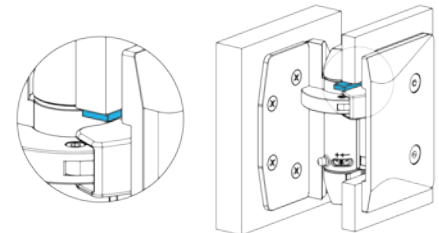



Watch the install video

## 530 Glass to wall for 10mm (3/8") - 12mm(1/2') glass

*NOTE: Speed or damper adjustments should only be done after the hinges are installed.*

*In most cases, the hinges will not need any adjustment.*

WATCH VIDEO [atlantichinge.com/install](http://atlantichinge.com/install)

### Increasing speed

1. Insert the speed tool all the way into the speed adjuster at the base of the arrow.

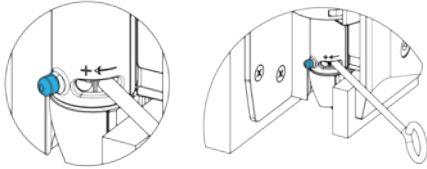

2. Apply pressure on the speed tool in the + symlbe direction until you can remove the speed pin. Then push the tool to the + symlbe to increase speed.

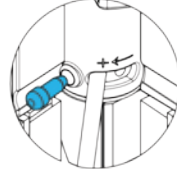

3. Insert the speed pin all the way back in, release the pressure of the speed tool and remove it.

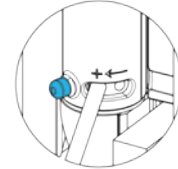

### Reducing speed

1. Insert the speed tool all the way into the speed adjuster at the + symbol.



2. Apply pressure in the + direction on the speed tool until you can remove the speed pin. Then allow the tool to rotate to the base of the arrow to reduce speed.

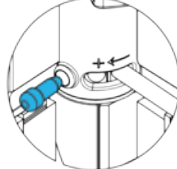

3. Insert the speed pin all the way back in, release the pressure of the speed tool and remove it.

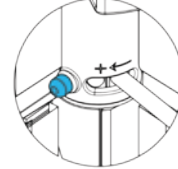

### Damper adjustment

Damper adjusters are numbered. The larger the number, the more damping. 15 is the highest and 12 is the lowest.



1. Open the gate and slide out the damper adjuster.

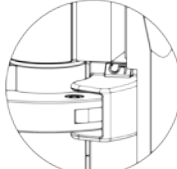

2. Insert the damper adjuster. Push in all the way.

#### TROUBLESHOOTING CHECKLIST

**Squeak Noise** - Check the spigots as they can cause this noise in some circumstances.

**Door closing slowly** - Check hinge panel alignment and speed adjustment and damper adjustment. If the problem persists, please contact Atlantic Hinge.

**Door slamming** - Check damper adjustment and reduce closing speed. If the problem persists, please contact Atlantic Hinge.